

York County Shore

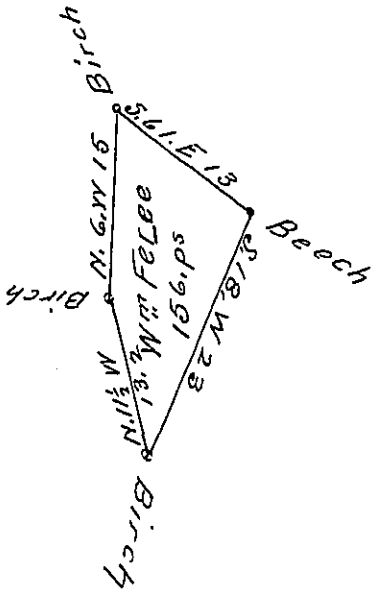

Lancaster County Shore

A Draught of an Island situate in the River Susquehanna
 opposite the Town of Falmouth and about eighty perches
 to the south (or below) John Elliots Island in Donigal
 Township Lancaster County containing one hundred
 and fifty six perches strict measure Surveyed in Purs
 - uance of a Warrant dated the 15th of May A. D. 1812 -

Granted unto William Ferree

pr. Jacob Hibshman D.S.

To Andrew Porter Esq:

Surveyor General

IN TESTIMONY that the above is a copy of the original remaining on file in
 the Department of Internal Affairs of Pennsylvania, made
 conformably to an Act of Assembly approved the 16th day of
 February, 1833, I have hereunto set my Hand and caused
 the Seal of said Department to be affixed at Harrisburg,
 this twenty ninth day of September 1904

Loose P. Brown
 Secretary of Internal Affairs.